

Details of installation

Installation of main bar

1. Firstly, please confirm how many installation holes the projector has? 3 or 4

2. If there are 3 holes, the installation arms need to be taken apart from installation bracket firstly. Connect 3 installation arms to the projector, and then connect the installation arms to the installation base. However, the installation base needs to be the center of projector. Figure 10.

3. Connect the installation arms to the projector conversely if the distance of installation holes is less than 120mm. Connect the installation arms to the installation base via sliding installation button as figure 11

4. Rotate the adjustable screw for adjusting the height of installation arms if the installation holes are not at the same level as figure 12.

5. The front or back of adjuster must be parallel to the surface of projector as figure 13.

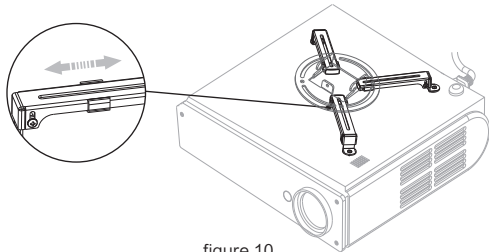

figure 10

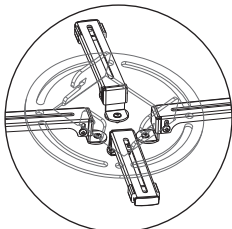

figure 11

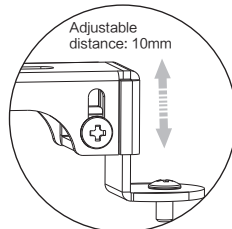

figure 12

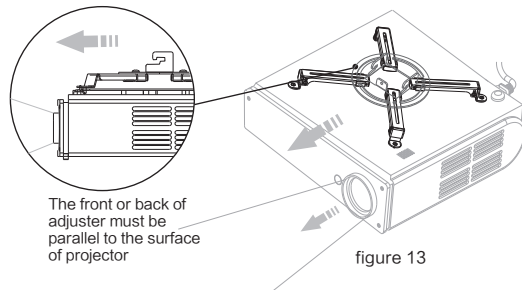

figure 13

Installation

- 4 With the projector installed to the installation base, hook the adjuster to the base as figure 14.

Tighten the screw of the adjuster to secure the base as figure 15.

Tighten the hexagon screw inside the adjuster to after your desired angle is set as figure 16.

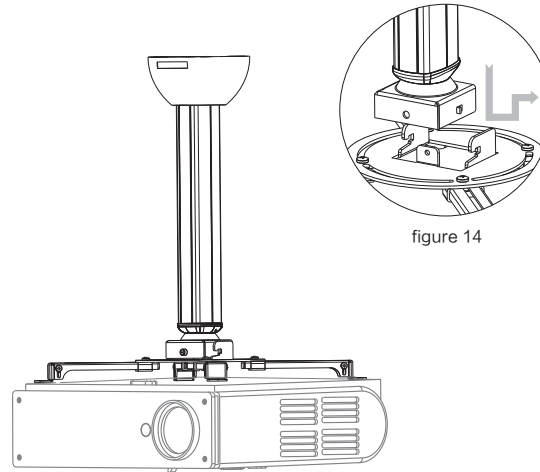

figure 14

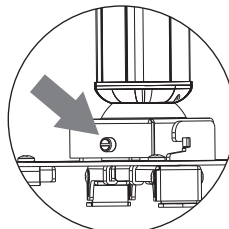

figure 15

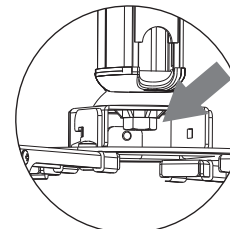

figure 16

Grandview®

Instruction Manual

Projector Lift

Applicable Model
GPCQ-F

Please read before using

Thank you for purchasing our products. Please read the instruction manual carefully in order to ensure this projector lift is suitable for your projection equipment.

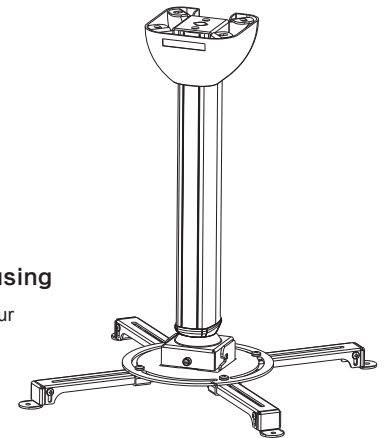

Cautious



Warnings

For safety, the minimum weight of ceiling must be 10Kg



Weight

The maximum weight of installation bracket is 10Kg



Caution

Do not over incline the projector.



Do not take apart

Do not take apart any components of the projector lift.

Grandview Crystal Screen Canada Ltd.

#11- 3751 North Fraser Way,
Marine Way Business Centre,
Burnaby, BC, Canada V5J 5G4
Tel: 1-604-412-9777 Fax: 1-604-412-9796
Website: www.grandviewscreen.ca

Guangzhou Grandview Crystal Screen Co., Ltd.

No.43,Guomao Road South, Hualong Town,
Panyu District, Guangzhou City, China
Tel: +8620-8489-9499 Fax: +8620-8480-3343
Website: www.grandviewscreen.com
www.grandviewscreen.com.cn

Parts

GPCQ-F

- A – Main bar
- B – Pillar base
- C – M5 x 15 screw (column)
- D – Top cap
- E – Spring
- F – Ø 5x22 cross screw
- G – Adjuster
- G-1 – Hook
- H – Extension arms
- I – Installation Base

Accessories:

- 1/ M6 x 25 anchor screw (4 set)
- 2/ Ø 6 x 50 wood screw (4pcs)
- 3/ M5 x 8 Philip screw (4 pcs)
- 4/ M4 x 8 Philip screw (4pcs)
- 5/ M3 x 8 Philip screw (4pcs)
- 6/ Hexagon screw (1pc)
- 7/ Tightening tool
- (1pc for installation base and the joint)
- 8/ Plastic belt

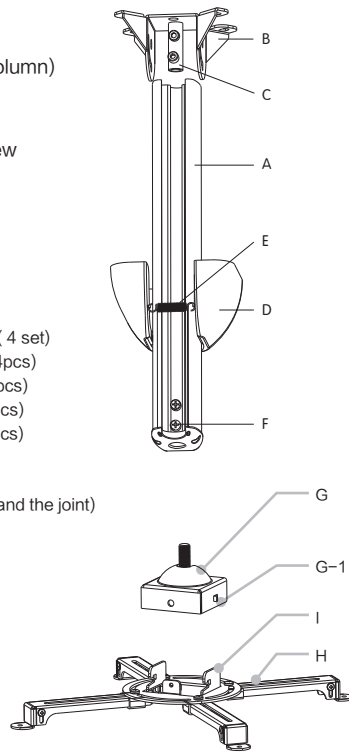

Scope

Scope for installation (Installation hole of projector):

Maximum scope for installation: 365mm diameter

Minimum scope for installation: 50mm diameter

Note: Connect the installation arms to the projector conversely for different installation holes of projector.

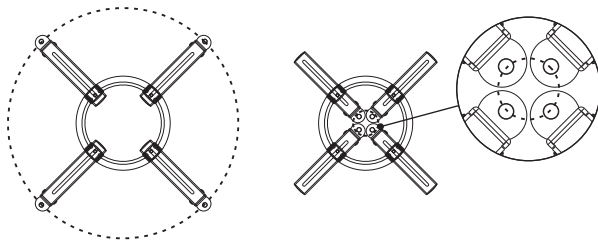

Maximum diameter: 365mm

Minimum diameter: 50mm

Scope

The total height of GPCQ-F is 750mm

The main bar (together with the plastic cover) can be cut by user into desirable height.

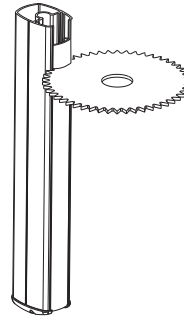

Installation

- 1** Fixation on the ceiling
(Figure 1) Locate the desired position of the concrete ceiling, install the pillar base onto it.
(Figure 2-3) Insert the main bar into the pillar base, then tighten it up by using M6x25 anchors screws. (Remark: it must be firmly tightened because it is the main supporting unit.)

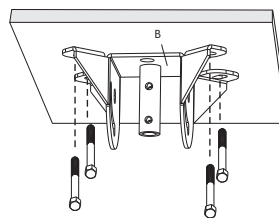

figure 1

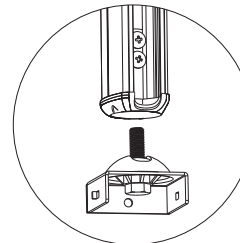

figure 2

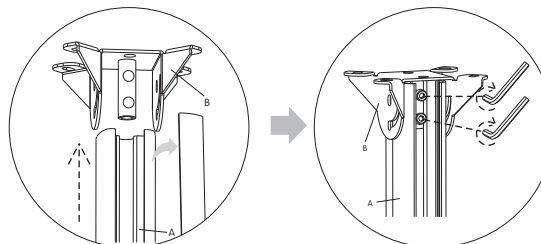

figure 3

Installation

- 2** Cable management
(Figure 4, 5) Place the cable into the cable duct on the back, close it with the plastic cover.
(Figure 6) Insert in the top cap to the main bar, then fasten with the added spring.

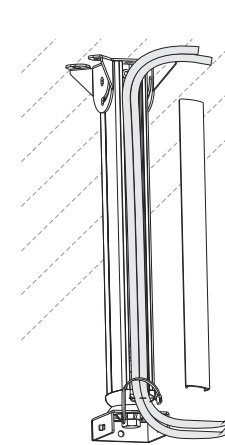

figure 4

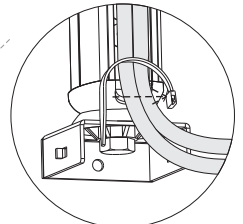

figure 5

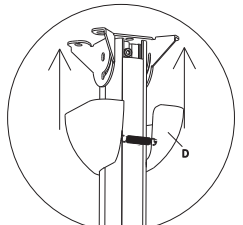

figure 6

- 3** Installation of the projector
(Figure 7) Position the arms on the installation holes of the projector. The arms are adjustable from the installation base.
(Figure 8) Please try to position the installation base on the center of projector.
(Figure 9) Tighten the screws.

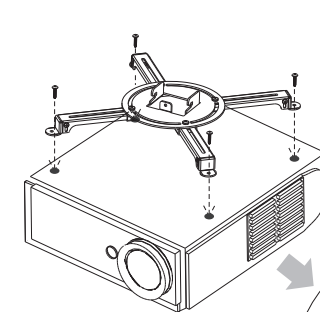

figure 7

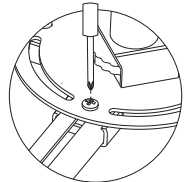

figure 9

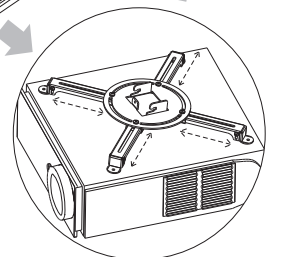

figure 8