

RS485 / RS232 port settings

- Data bits : 8
- Start bits : 1
- Stop bits : 1
- Baud rate : 2400

Hex Control Code

- UP : FFFFFFFEEDD
- STOP : FFFFFFFECC
- DOWN : FFFFFFFEEE
- Some central controls need to set the address code : FFFFFFFEAA
- Learn address code instructions : FFXXXXAA
(XXXX is a hexadecimal character other than E and 5)

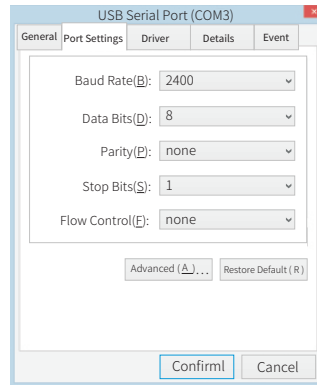

Note:

When connecting to RS232 or RS485, if there is any motion that cannot be controlled by the screen, please switch the two control wires; Wiring loop resistance is less than 20Ω;
Do not run in parallel with strong interference sources;
230 port settings: 2400, n, 8, 1 a data string must be sent twice consecutively;

Adjusting method of screen retracted height (upper limit) and expanded height (lower limit):

If it is really necessary to adjust the limit height due to the installation environment or site limitation, you can use the motor positioning adjustment key to rotate the knob on the motor limiter; the limiter adjustment knob is located in the 12 round hole next to the power cord outlet.

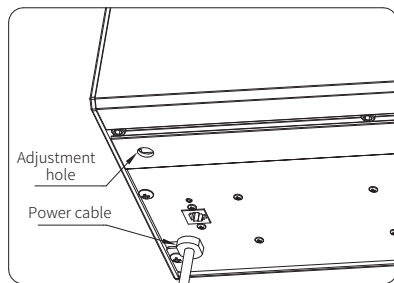

Green button
Retracted height(upper limit)
Clockwise down
Counterclockwise up

Yellow button
Unfolding height (lower limit)
Clockwise Up
Counterclockwise Down

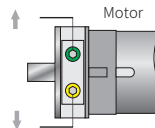

Pay attention:

In order to ensure the accuracy and safety of the screen position, the screen must be raised and lowered after each half-turn of the button to check whether the position has been moved correctly!
Special care should be taken when adjusting the screen recovery height. Excessive adjustment will cause the lower rod to be caught in the casing, causing serious consequences of damaging the curtain or falling the lower rod!
Care must also be taken when adjusting the height of the screen deployment. Make sure that the length of the cable extension is within 5 meters. Excessive adjustment will cause the cable runner to reverse and the screen cannot be recovered. Electrical parameters: voltage AC220 ~ 230V / 50-60Hz, current 1.5A.
Wireless remote control (F): voltage 3V, using battery CR2032X2, transmission frequency; 868MHz, effective control distance of about 15 meters.

Guangzhou Grandview Creative Technology Co., Ltd

Add: No.1 Building of No.43 South International Trade Avenue, HualongTown,
Panyu District, Guangzhou China.
Tel: +8620-8489-9499 Fax: +8620-8480-5299
Web: www.grandviewscreen.com



Grandview®

User Manual for Skyshow Series Model CIII

Integrated Motorized Screen Suitable for
Model Named SK-MFXX(C3)(AGWW)

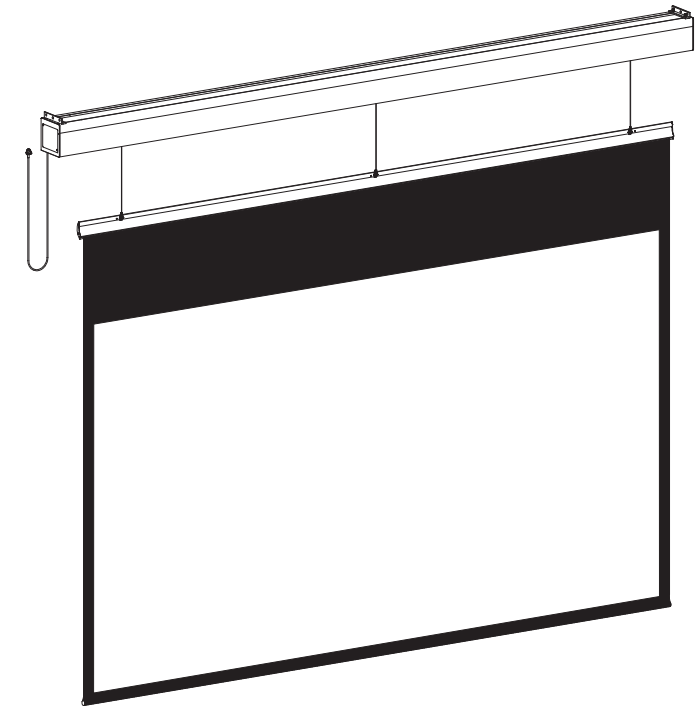

Warm reminders

- Thank you for choosing Grandview products. Please read the manual carefully before installation and use, and keep it in your collection for future reference.
- This product must be installed by a qualified professional after assessing the feasibility of environmental, power, and structural safety.
- Before you turn on the screen, make sure you have cleared all the stickers that fix the bottom bar and the case of the screen.
- It is forbidden to control the screen wire to rise and fall under the condition that the screen wire is not taut or the screen is hanging naturally.

Screen structure

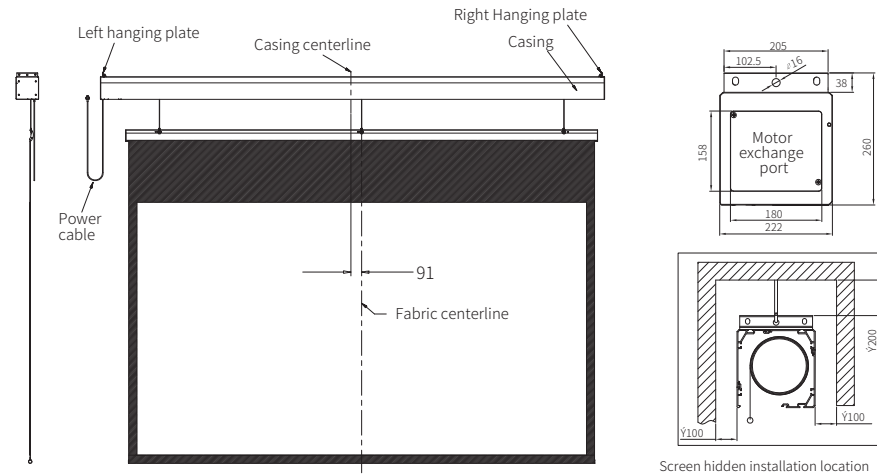

Accessories



Installation method and precautions

Note: Due to structural reasons, the position of the screen is not the center of the screen, but it is offset by about 91mm to the right. This should be taken into account when determining the location of the mounting hole; it is also recommended to keep a distance of 0.4 meters on the side of the screen power cord for future service.

Suspension installation

Measure the horizontal distance of the hanging plate (the hanging plate can adjust the position within the size range according to the actual situation), and determine the installation position of the screen with the length of the product. Recommended hook type is adjustable;

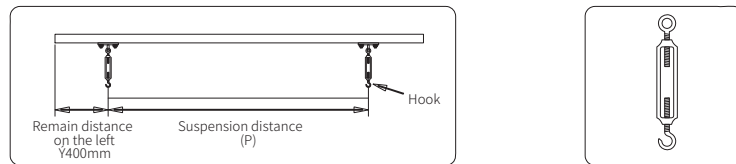

Hook the hooks to the middle circular holes on the left, middle and right hanging plates respectively, adjust the length of the hooks to the level of the screen, and complete the lifting; (Note: The left and right hanging plates are the main stress points, and the middle hanging plate is the secondary stress point. and the middle hanging plate is only suitable for shell length 6 Y meters, less than 6 meters, no need to install the middle hook)

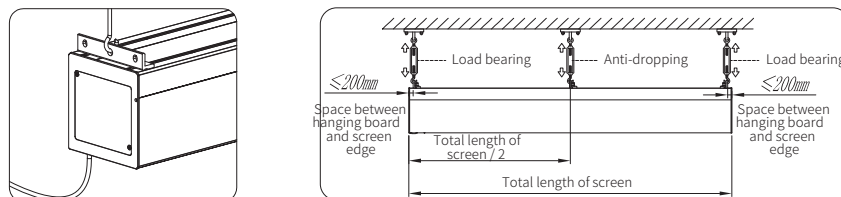

Screen control function description



Warning:
To protect the internal steel cable structure, a start button has been added. Please completely remove the yellow tape used to secure the screen before powering on. Failure to do so may damage the internal cable system and pose a safety hazard.

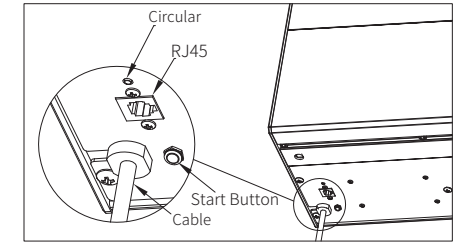

Intelligent electric screen has 5 control methods:

- Manual control (cycle button)
- Wireless control
- Dry contact control
- RS485 or RS232 control
- DC12V Trigger

Manual control

The manual control button is on the left end of the screen casing (near the RJ45 interface). This button is a circular control button.

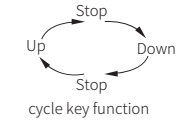

Wireless control

Press the up button, the screen will rise
Press the stop button the screen stop
Press down button, the screen drops
Positioning Button: Short press positioning button to set the electronic travel limit. Press and hold for 5 seconds to swap the functions of the Up and Down buttons.

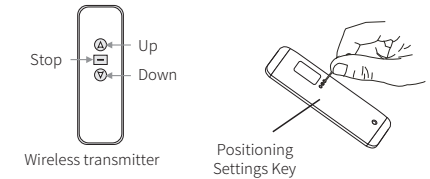

Code pairing / deleting (pairing is successful when leave factory)

The first type: long press the cycle button for 3 seconds, the screen is jogged once to enter the code-matching state; within 10 seconds, press the remote control up and stop keys simultaneously, the screen is jogged again to complete the code-matching; code deletion is the same as code-coding Odd times are pairing; even times are deleting.

The second type: disconnect the independent power of the screen for 10 seconds and then reconnect the power. Press the remote control up and stop buttons simultaneously within 10 seconds, the screen is jogged a little, and the code is

Code deletion is the same as code pairing operation. The odd operation is code pairing and the even operation is code deletion.

Intelligent electronic stroke positioning (this product can set the up and down stroke of the curtain through the remote control)

Operation method:

Upward stroke setting: Positioning setting key (light on) → Up key → Up and down remote control to the desired position → Stop → Positioning setting key (light off) → Upward travel record success
Downstroke setting: Positioning setting key (light on) → Down arrow key → Remote control up and down to the desired position → Stop → Positioning setting key (light off) → Downstroke recorded successfully

Control via Dry Contact, RS485, RS232, or DC12V Trigger:

RJ45 each line menu								
Connection port line number	1	2	3	4	5	6	7	8
Function	RS485-B RS232-GND	RS485-A RS232-TXD	Stop	Up	Down	12V+	12V-	Public line

