

Grandview[®]

User's Manual for Large Flat Series Edge Fixed Frame Screen

Grandview[®]

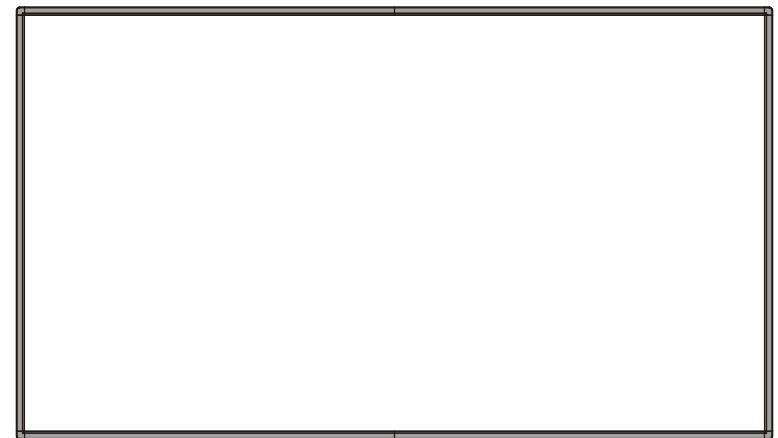

Model LF-PExxx

Thank you for purchasing a Grandview projection screen.

Before use, please read instructions carefully. After installation, store instructions for future reference.

Note: Please make sure the concrete ceiling is strong enough to be bear the weight of 20kg or above in order to avoid any property lost and casualty due to insufficient bearing.

Guangzhou Grandview Creative Technology Co., Ltd

Add: No.1 Building of No.43 South International Trade Avenue, HualongTown,
Panyu District, Guangzhou China.

Tel: +8620-8489-9499 Fax: +8620-8480-5299

Web: www.grandviewscreen.com



Product Structure

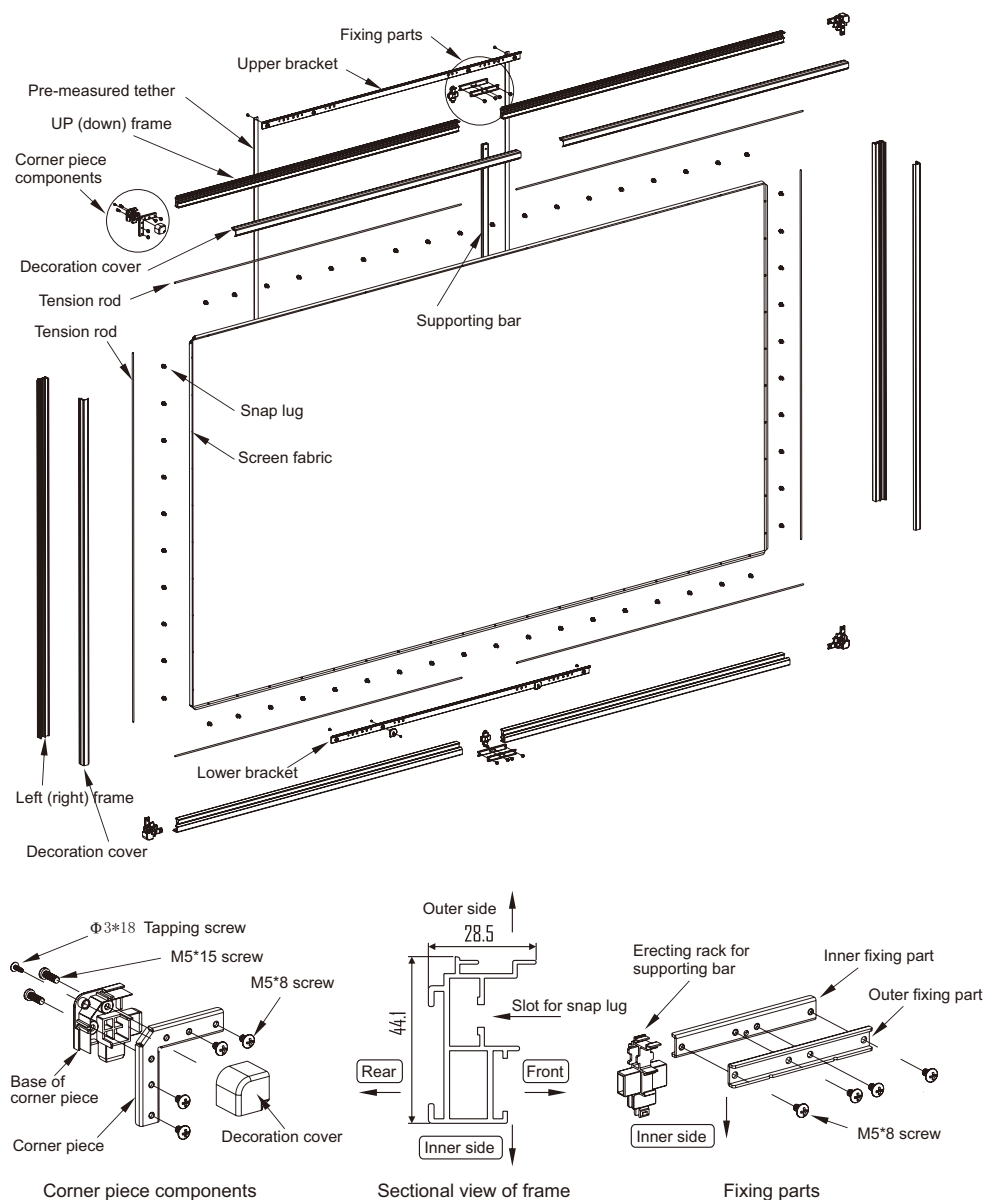

Sketch for structure of Edge fixed frame screen

Note

1. Please pay attention to the rear and front sides of screen fabric during installation. There is label attached to rear side of screen fabric.
2. Kindly handle with care to avoid distortion due to crash of the aluminum frame material.
3. In case of infrequent use, please cover the screen fabric with cloth (or something else fit to cover) to prevent screen fabric from dusty.
4. Do not clear screen fabric with detergent of corrosivity such as diluent.
5. Please clean the velvet wrapped on the frame along the velvet grains. Prevent velvet from crash to avoid damage.
6. Do not scrape screen fabric with fingers or edge tool, which would leave flaws or marks on fabric.
7. In order to avoid any unexpected injury, it is advisable to manage and install the fixed frame screen by adult.

Warning: Regardless of the warnings would possibly lead to damage to product or casualty due to any improper operation.

Mandatory: The screen should be installed where is strong enough to bear its weight, or it would cause accident by falling off.

Note: Please don't disassemble screen for replacement of parts. Please kindly contact to after sale department for service if any fault. It is not prior to notice if there is any change on product. Please refer to the product.

Parts List

- | | |
|--|---|
| ■ Up and down frames(4 pcs in equal length) | ■ Left and right frames(2 pcs in equal length) |
| ■ Decoration cover for up and down frames (4 pcs in equal length) | ■ Decoration cover for left and right frames (2 pcs in equal length) |
| ■ Φ5mm tension rods for up and down frames (4 pcs in equal length) | ■ Φ5mm tension rods for left and right frames (2 pcs in equal length) |
| ■ Supporting bar (1 pcs) | ■ Mounting brackets with pre-measured tether (1 set) |
| ■ Screen fabric (1 pcs) | |
| ■ Corner piece parts (4 sets) | ■ Cover for corner piece (4 pcs) |
| ■ Erecting rack for supporting bar(4 pcs) | ■ Snap lug (provided according to screen size) |
| ■ Inner fixing parts for frame (2 pcs) | ■ Outer fixing parts for frame (2 pcs) |
| ■ M5*8mm screw (24 pcs) | ■ Φ3*8mm tapping screw (4 pcs) |
| ■ Φ5*40 tapping screw (4 pcs) and expansion tube(4 pcs) | |
| ■ User's manual (1 copy) | ■ Warranty card (1 set) |
| ■ Qualification certificate (1 set) | |

7. Assembly of screen fabric

- Make sure the screen fabric is assemble in the place where is clean and tidy.
- Please put the rolled screen fabric onto frames with front side of fabric facing up, then roll the fabric to spread slowly. (diagram 19)
- Please put the tension rods through 4 edges of fabric. Please be noted that the 2 pcs of left and right tension rods are in the equal length, so are the 4 pcs of up and down tension rods.
- Adjust distance from snap lugs according to the snap lugs's holes at the edges of fabric, then hold the fabric with hands to put the snap lugs go through the holes. (diagram 21) (It is advised to handle the snap lugs on up and down frames. Snapping from middle to edges.)
- Please make necessary adjustment on fabric to keep it smooth and flat from wrinkles.

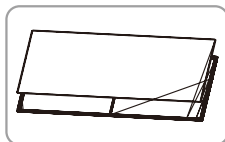

Diagram 19

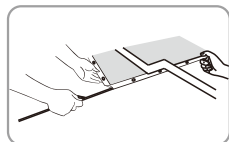

Diagram 20

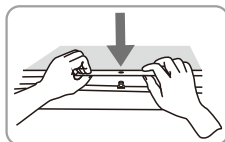

Diagram 21

8. Installation of cover for corner piece and frame

- Mount the cover for corner piece onto the slot of base and use $\approx 3 \times 8$ mm tapping screws to fix it. (diagram 22)
- Mount the frame cover with rubber onto the frame and press it down in position until it is tight. (see diagram 23-24). The frame cover with label should be placed onto lower right corner at the front side of screen.

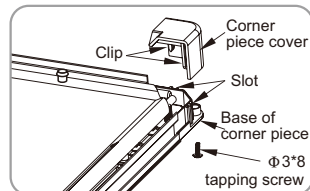

Diagram 22

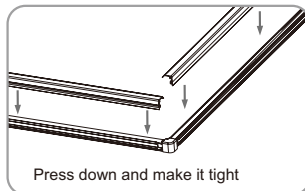

Diagram 23

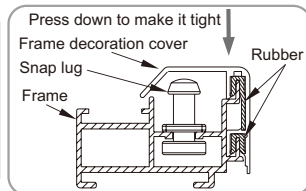

Diagram 24

9. Assembly of bracket set and mount the screen onto wall

- Please find out the position to put the screen and drill holes in wall according to the mounting holes of bracket. Please fix the bracket onto wall with the expansion tubes and screws provided.
- Please let the lower bracket drop naturally and it would be in position with help of the pre-measured tether. Please mark the position of mounting holes for lower bracket, drill the holes and fix the lower bracket with expansion tubes and screws provided.
- Measure distance from upper and lower brackets which should be $H+2$ mm. Please make necessary adjustment if the distance doesn't meet the above.
- Turn the buckle on lower bracket counter clockwise until it reaches the end to make the lock mark on the buckle stops at direction of 12 or 3 o'clock (upright or right position) to make it unlock (see diagram 26)
- Please mount the screen onto brackets. Make sure hooks of brackets go in the slots of up and down frames. (see diagram 27-28)
- Please finish the installation by turning the buckle clockwise until it reaches the end to lock the lower frame. (see diagram 26 on the right and diagram 29)

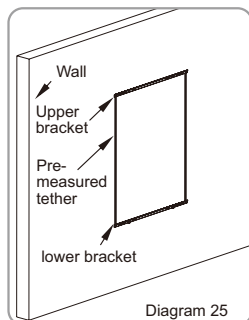

Diagram 25

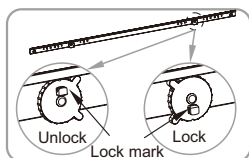

Diagram 26

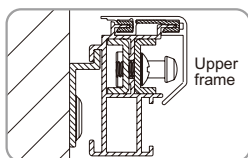

Diagram 27

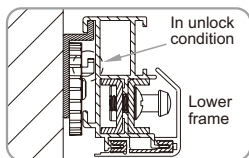

Diagram 28

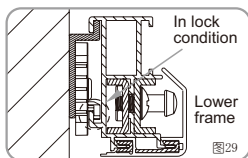
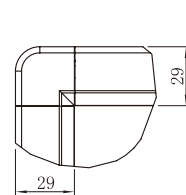
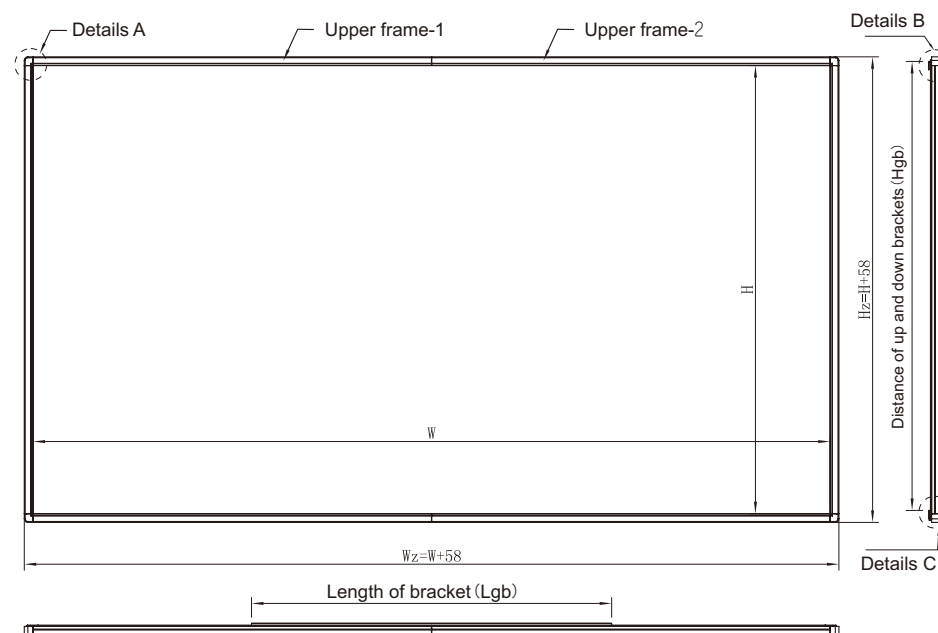
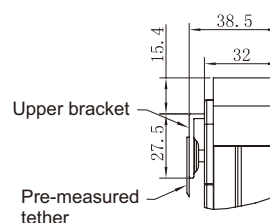

Diagram 29

Overall view and dimension



Details A



Details B

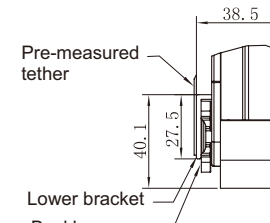

Details C

Specification (Inch)		16:9								16:10								2.35:1							
		60"	72"	80"	84"	92"	100"	106"	120"	60"	72"	84"	92"	100"	106"	120"	60"	72"	80"	84"	92"	100"	106"	120"	
Width of viewing size	W	1328	1594	1771	1859	2037	2214	2346	2656	1292	1551	1809	1982	2154	2283	2585	1402	1683	1870	1963	2150	2337	2477	2805	
Height of viewing size	H	747	896	996	1045	1145	1245	1319	1494	808	969	1131	1239	1346	1427	1615	597	716	796	835	915	995	1054	1193	
Overall width of the screen	Wz	1386	1652	1829	1917	2095	2272	2404	2714	1350	1609	1867	2040	2212	2341	2643	1460	1741	1928	2021	2208	2395	2535	2863	
Overall height of the screen	Hz	805	954	1054	1103	1203	1303	1377	1552	866	1027	1189	1297	1404	1485	1673	655	774	854	893	973	1053	1112	1251	
Nos. of snap lug for the up and down frame	KDh	6	8	10	10	12	12	12	14	6	8	10	10	12	12	14	6	8	10	10	12	12	14	14	
Nos. of snap lug for the left and right frame	KDs	4	6	6	6	6	8	8	8	4	6	6	6	8	8	8	4	4	4	5	6	6	6	6	
Distance of up and down brackets	Hgb	749	898	998	1047	1147	1247	1321	1496	810	971	1133	1241	1348	1429	1617	599	718	798	837	917	997	1056	1195	
Length of bracket	Lgb	800	800	800	1000	1000	1000	1000	1200	800	800	1000	1000	1000	1000	1200	800	800	800	800	1000	1000	1000	1200	
Length of packing size	Lg	917	1066	1166	1215	1315	1415	1489	1664	978	1139	1301	1409	1516	1597	1785	836	977	1070	1117	1210	1304	1374	1538	

Installation instructions

Open the package and take out all of the parts. Kindly check the types and quantity of the parts according to user's manual. Please put all of frames on clean and flat dest or ground in a square. (see diagram 1) Please pay attention to correct placement of aluminum frames. (the front side should be facing up, while the inner side should be facing the center of the screen). Please follow the order shown in diagram to assemble the frames.

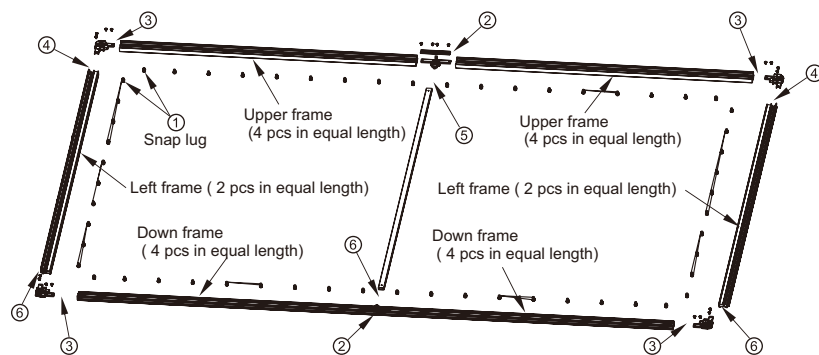

Diagram 1

1. Please put the snap lugs into lug's slot of frame (see diagram 2) according to the Nos. of holes in the screen fabric.

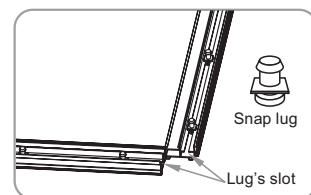

Diagram 2

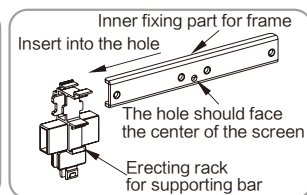

Diagram 3

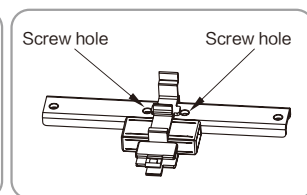

Diagram 4

2. Joint of up and down frames

- Put the inner fixing part for frame through hole on the base of supporting bar (see diagram 3). Please pay attention to the difference of inner and outer fixing part of frame. The inner fixing part is with 5 holes, 4 out of which has screw thread. The middle hole of inner fixing part should face the center of screen. It would cause failure in assembly if mistaking the inner and outer fixing part or the incorrect placement of it. Please refer to diagram 4 for correct assembly.
- Please insert the base of supporting bar with inner fixing part mentioned above into the frame (diagram 5) to join the 2 pcs of upper frames together. Please be noted that the base of supporting bar should be inserted till it reaches the end to avoid any apparent seam between frames and the base of supporting bar.
- Assembly of outer fixing part for frame. There are 4 holes in it and 2 gaps on the edge. The gaps should face the center of screen (diagram 6). Please put the outer fixing part onto the slot for snap lugs and adjust its position to match the holes of inner fixing part with screw thread. Please fix the inner and outer fixing parts with M5*8 screws (diagram 7).
- Assemble lower frame in the same way.

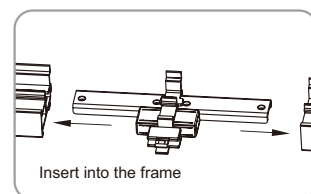

Diagram 5

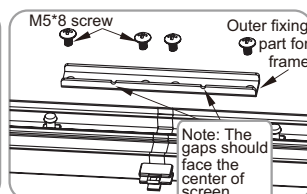

Diagram 6

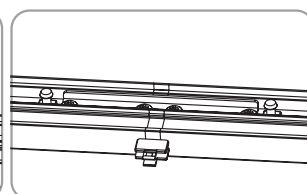

Diagram 7

Installation instructions

3. Assembly of corner piece

- Please insert corner piece into the slot of horizontal frame till it reaches the end. There should not be any apparent seam found. Please use M5*8 screw to fix it, see diagram 8-10.
- Assemble other corner piece in the same way.

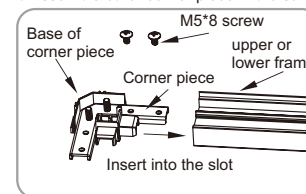

Diagram 8

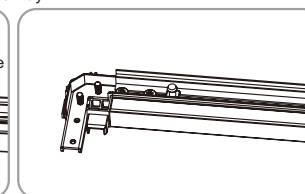

Diagram 9

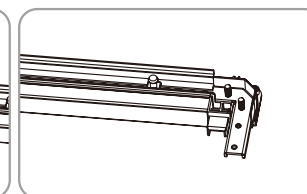

Diagram 10

4. Join the frames together

- Please insert the other side of corner piece into the vertical frame till it reaches the end. There should not be any apparent seam found. Kindly use M5*8 screw to fix it, see diagram 11-12.
- Join the other vertical frame with up and down frame in the same way, see diagram 13.

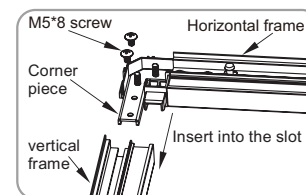

Diagram 11

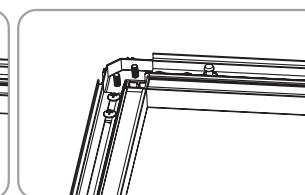

Diagram 12

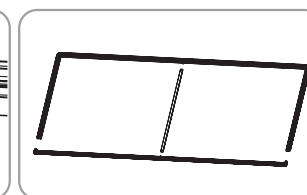

Diagram 13

5. Assembly of supporting bar

Attach the supporting bar with the erecting rack along the extending part on it till it reaches the end and the hook would clip into the square hole in the supporting bar, see diagram 14-15.

Note: It is not advise to disassemble or assemble the supporting bar frequently. If it is necessary, please use the flat screw driver to insert into square hole in supporting bar to unlock the hook for disassembly, see diagram 16.

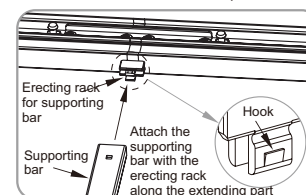

Diagram 14

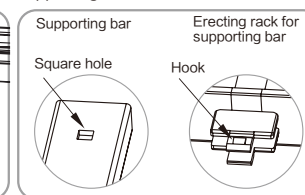

Diagram 15

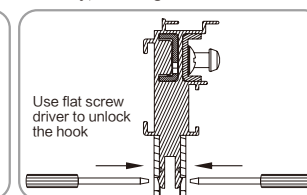

Diagram 16

6. Join the other set of horizontal frame

Join the other set of horizontal frame with the vertical frames with screw in the same way as the step 4 and step 5 mentioned above, see diagram 17-18. Please check it again to see if all of the screws are tighten.

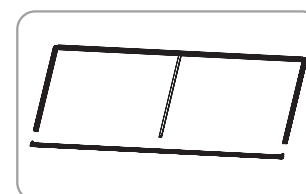

Diagram 17

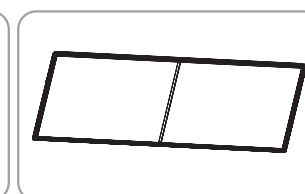

Diagram 18