

Grandview

Instruction Manual

X – Arm Projector Lift

Models

GPSC-5006

GPSC-5010

GPSC-5015

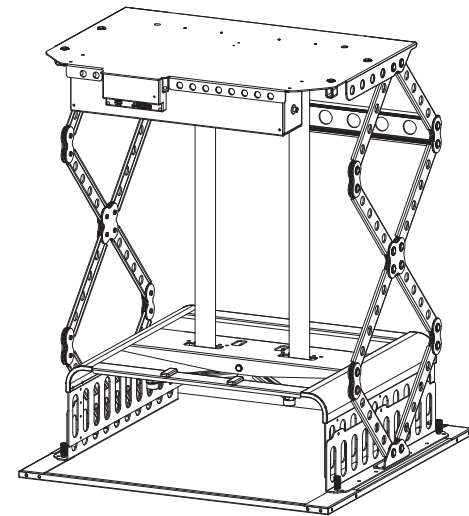

Grandview

Guangzhou Grandview Creative Technology Co., Ltd

Add: No.1 Building of No.43 South International Trade Avenue,
Hualong Town, Panyu District, Guangzhou China.

Tel: +8620-8489-9499 Fax: +8620-8480-5299

Http://www.grandviewscreen.com



Grandview

Thank you for purchasing this product. Before use, please ensure that the mounting bracket is suitable for your projector equipment and read this manual carefully.

Important safety instructions

WARNING: To reduce the risk of fire or electric shock, do not expose product to rain or moisture.

- Please read this manual before installation and use to avoid damage to the product due to improper installation and use.
- Keep away from heat sources such as radiators, heaters, stoves and other equipment (including amplifiers).
- Only power plugs with grounded conductors may be connected.
- Only use accessories provided by the supplier.
- If you encounter lightning storms or if the product is not used for a long time, please unplug the power cord.
- Please leave it to professional service personnel for installation and maintenance.
- Never install the product in a humid or location where water may be splashed.
- This unit is not disconnected from AC power as long as the product plug is connected to the power source.
- Please use a power cord (3-core wire/device/connector/plug) that meets specific ratings (voltage, current). If the above power cord/device interface/plug, if you have any questions about its use, please consult professional maintenance personnel.
- Please use an approved power cord (3-core power cord)/device interface/plug, and its grounding plug should comply with applicable national safety regulations.
- When installing this equipment, provide an easily accessible disconnect device in the fixed wiring, or connect the mains plug to an electrical outlet that is close to the equipment and easily accessible. If a malfunction occurs while operating the device, the device can be disconnected by cutting power to the de-energized device power supply, or disconnect the power plug.
- The installation location must have sufficient mechanical strength, and the load-bearing requirement is 4 times the weight of the projector lift. Otherwise, an accident may occur or the lift may fall off.
- The ceiling cutting height must be greater than the product height; otherwise, it cannot be installed properly. Please ensure The ceiling installation height exceed the product height by at least 100mm.



Note:

Objects other than projectors cannot be mounted.



Disassembly prohibited:

Please do not disassemble or disassemble the components of the mounting bracket.

This installation and operation manual is written for dealers and installation technicians. Customers are advised not to install it by themselves. They must hire qualified professional technicians to install and follow the installation instructions.

Troubleshooting

The projector lift is designed to provide years of trouble-free use, and many problems arise due to simple little things. If you find an issue, check out the list of simple fixes below.

	Reasons	Solutions
Lift stand fully installed but not functioning properly	The positive and negative poles of the transmitter battery are reversed or the battery power is insufficient.	Refer to the instruction manual to check whether the battery is installed backwards. If the fault is not eliminated, replace the battery.
	The power cord is not connected properly	Refer to the instruction manual to connect the power cord and plug it in tightly.
Remote control does not respond	Poor reception/blocked signal	Restart the lift power
Restart the lift power	The rear signal line is blocked	Deal with the wire direction/adjust the lift position

b. Clearing the electronic upper limit: Move the lift to the set upper limit, then press and hold the "stop" button for 5 seconds until you hear a quick beep, indicating it's in clearing mode. Press the "stop" button again for 5 seconds; a long beep will confirm the upper limit has been cleared.

2. Electronic lower limit setting/clearing:

a. Electronic lower limit setting: Lower the lift to your desired position, then press both the "stop" and "down" buttons on your remote simultaneously. A long beep will sound, putting the lift into lower limit setting mode. Press both buttons again to hear a short beep, which means the lower limit is successfully set.

b. Clear the electronic lower limit: Adjust the lift to its lower limit, press and hold the "stop" button for 5 seconds until a quick beep sounds, indicating it's ready to clear. Pressing the "stop" button again for another 5 seconds will be followed by a long beep, signifying the successful clearing of the lower limit.

RS-485 Protocol

1.RS-485 port settings

- a.Baud rate:2400
- b.Data length:8
- c. Parity check:N
- d.Start bi: 1
- e.Stop bit:1

2.Control code

- a.Rise command: FFAAEEEEDD
- b.Stop command: FFAAEEEECC
- c.Descending command:FFAAEEEEEE

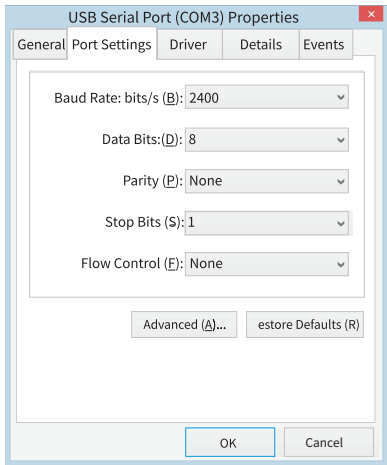

Parts

GPSC-5006 Ultra-Thin Motorized Projector Lift

- ①-Ultra-thin Top Plate
- ②-Power Cloth Belt
- ③-Scissor Arm
- ④-Motor Components
- ⑤-Control Motherboard
- ⑥-Projector Mount
- ⑦-Decorative Base Plate

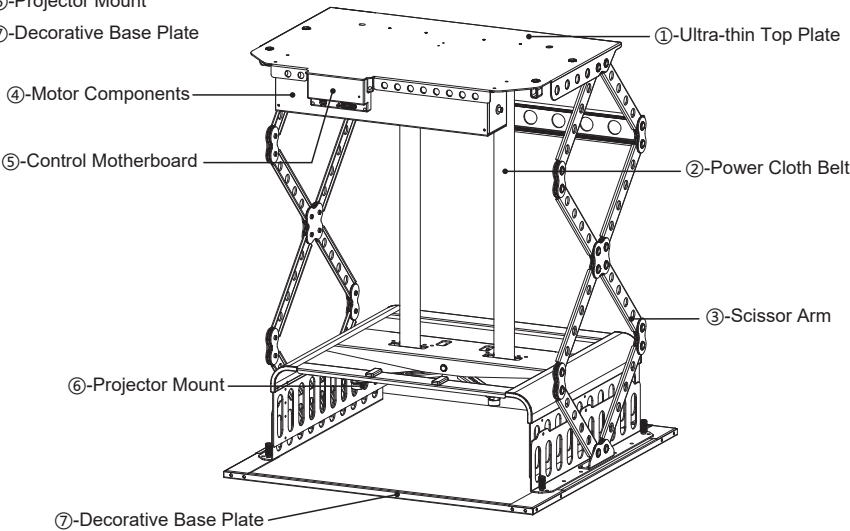

Accessories

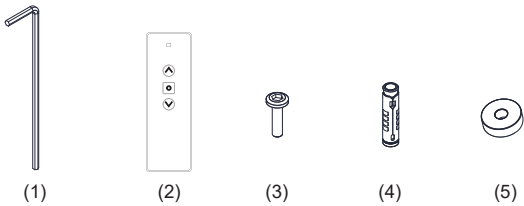

- | | |
|-------------------------------|--------------------------------|
| (1) Allen Key 1pcs | (4)M8 Expansion Anchor 4pcs |
| (2)Remote Control 1pcs | (5)Mounting Spacer 4pcs |
| (3-1) M5x30 Socket Screw 4pcs | Certificate of Conformity 1pcs |
| (3-2) M4x30 Socket Screw 4pcs | Warranty Card 1pcs |
| (3-3) M5x20 Socket Screw 4pcs | Instruction Manual 1pcs |
| (3-4) M4x20 Socket Screw 4pcs | |

Installation

Installation instructions

This product is suitable for installation in various suspended ceilings. This manual takes the installation method of the grille ceiling as an example. Please install it according to different installation environments. This product should be installed in the best projection position. Correct installation will make the product more convenient and safer during use. Open the packaging box, check whether the spare parts are complete, then take them out and put them in a suitable place for installation according to the following operation methods.

* For the safety and convenience of the lift, please read the entire installation section of the instruction manual and choose the most suitable installation method according to your actual site conditions!

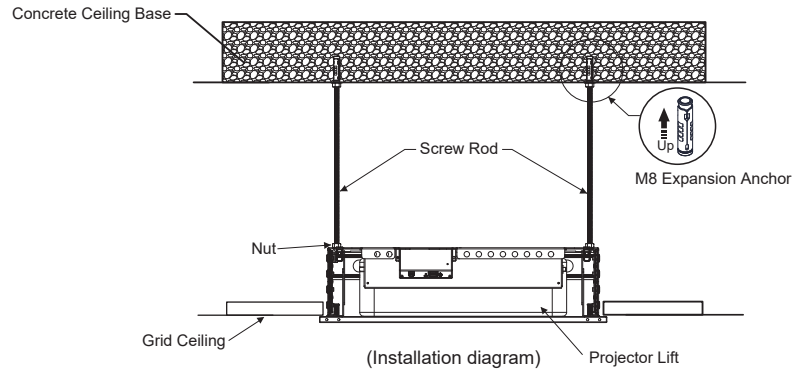

Parameters

Product Parameters:

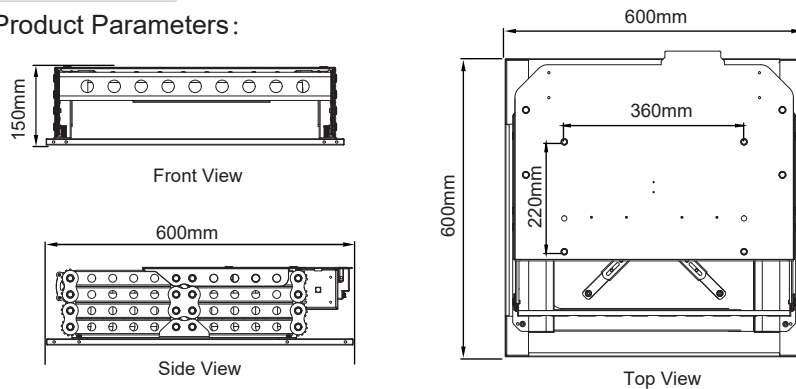

Model: GPSC-5006

Product Dimensions: W600xD600xH150mm

Installation hole distance: W360xD220mm

Rated voltage: AC 110~120V/60Hz Or AC 220~240V/50Hz

(Actual voltage shall be subject to the electrical label shown on the product)

Rated power: 145W

Weight capacity: 15kg

Remote Functions Guide

Remote Functions

1. LED Indicator light: When a function key is pressed, the LED light will flash once.

2. Press the up button and the projector lift will rise.

3. Press the stop button to stop the projector lift.

4. Press the button to lower the projector lift.

5. Remote Control Pairing: Within 10 seconds after the lift is powered on, press and hold the "Up" button on the remote control for 3 seconds to enter the pairing mode. Release and then press the "Up" button on the remote control for another 3 seconds. When the buzzer emits a long beep, the learning process is successful.

(Note: The remote control has been paired and learned at the factory.)

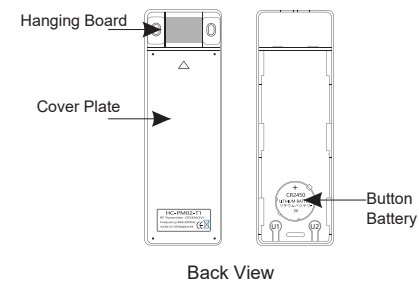
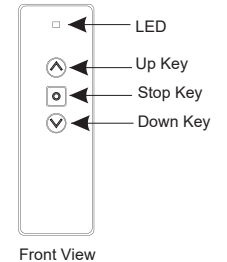

Precautions when using remote control

1. Working temperature: -20°C to ±70°C.
2. Transmitter battery: 1 CR2450 3v button battery.
3. When the signal from the remote control is weak, please replace the battery.

Remote control battery replacement and installation

When the signal from the remote control is weak, please replace the battery as follows:

1. On the back of the remote control, remove the hanging plate, push upward in the ▲ direction, and take out the rear cover of the remote control.
2. Insert a small screwdriver into the square hole, tilt it down slightly, and remove the button battery.
3. Install the new battery, paying attention to the negative terminal of the button battery facing inward.
4. Place the rear cover ▲ and push it down into place. The battery replacement is completed.

Electronic Limit Settings

The upper/lower limit of your projector lift can be set/cleared via the remote control:

1. Electronic upper limit setting/clearing:

- a. Electronic upper limit setting: Once projector lift reaches your desired height, press both the "stop" and "up" buttons on your remote simultaneously. A long buzzer sound indicates the lift is in upper limit setting mode. Press both buttons again to hear a short beep, confirming the upper limit is set.

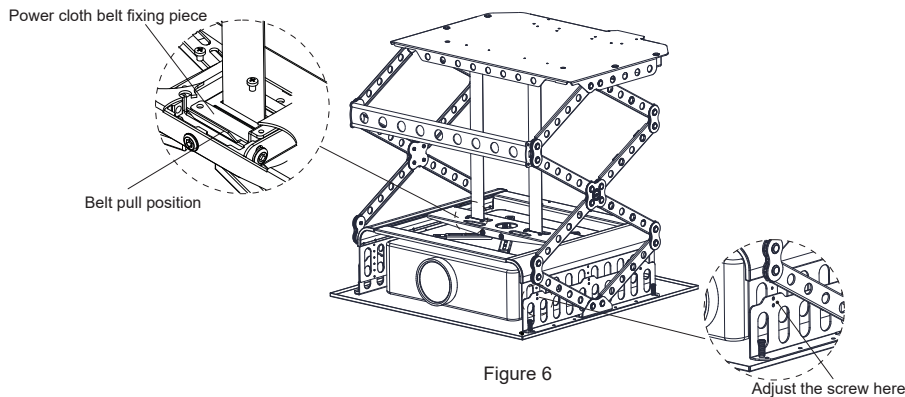

4. As shown in Figure 6, you can loosen the screws in the cloth strap fixing piece to pull the cloth strap to reduce the height of the projector (0mm-600mm). In addition, when encountering a larger projector, you can loosen the originally fixed screws and adjust them to the screw holes suitable for the height of the projector as shown in Figure 6-2.

Electrical and Installation Instructions

Connect the power cable and signal cable, as shown in Figure 7

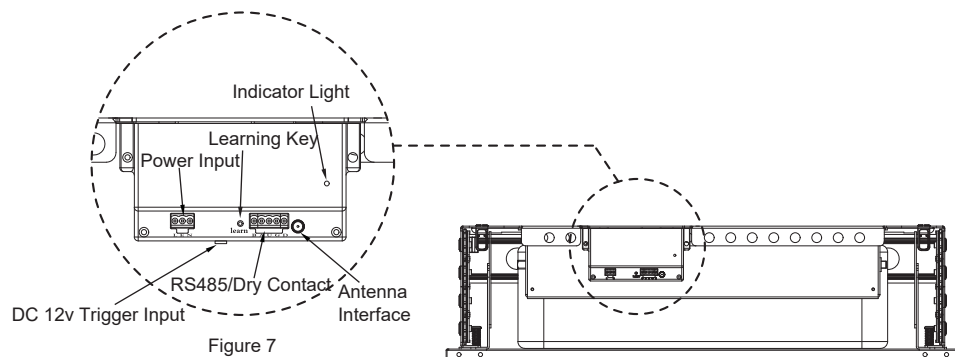

L: Live wire, E: Ground wire, N: Neutral wire

φ2.5 interface: DC 12v trigger input

B: RS-485-, A: RS-485+

U: Up, G: public, D: Down

OOOnce G and U touch, the lift will rise; if they touch again, the lift will stop;

Touch G and D once and the lift will decent; touch again and the lift will stop;

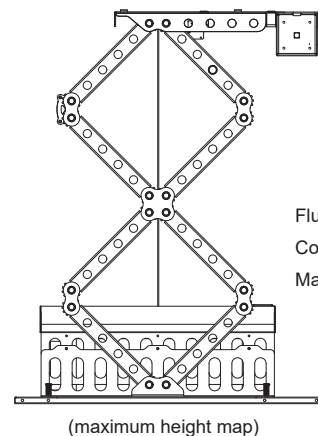

Table 1

unit: mm

Model	Name	Travel height range	Maximum load bearing capacity(KG)
GPSC-5006	Single X node	500	15
GPSC-5010	Double X node	1000	12
GPSC-5015	Triple X node	1500	10

Flush Installation: The projector's decorative base plate is flush with the ceiling

Cover Installation: The decorative base plate of the projector just covers the ceiling

Maximum projector installation size:W480xD470xH160mm

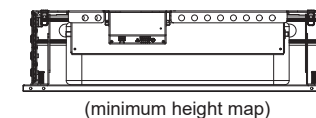

According to the model of the projector lift as shown in the figure and table, refer to the size range of the projector lift to determine the size of the ceiling opening. If the ceiling is higher than the minimum height, please install it with screws. If the ceiling is lower than the minimum height, it is recommended that the ceiling opening size be larger than the reference value.

Finally, the user chooses the installation method based on the actual situation. (Refer to the lifting frame model: Table-1. Note that the ceiling opening must ensure that the projector lift is not blocked.)

Ceiling opening size

For cover installation: 585 mm x 585 mm

For flush installation: 610 mm x 610 mm

Installation Steps

Projector ceiling mount installation

1. Select the installation location, (we recommend installing on the ceiling cement base) use an impact drill to drill holes for positioning, screw the M8 Expansion Anchor into the ceiling base, and then follow the order in Figure 1, sequentially put on the M8 screw, and tighten the installation. Note that the installation location here must ensure that it can bear the weight of the electric hoist and the projector to prevent the hoist from falling off and causing accidents.

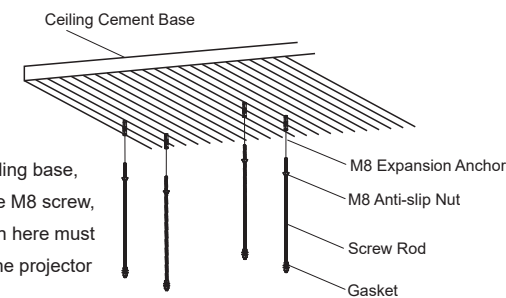

Figure 1

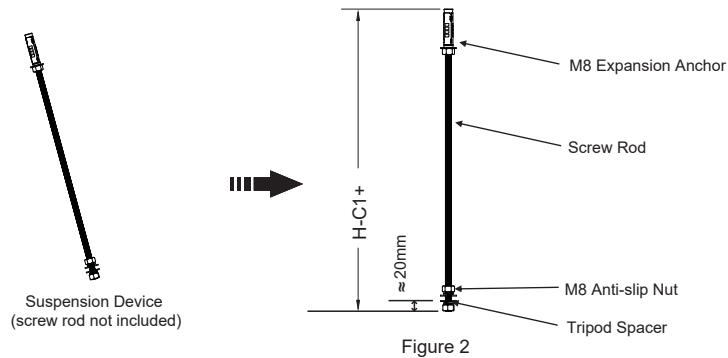

Figure 2

2. Assemble the suspension device using the parts in figure 2. Cut the rod (M8) to a length of: $H-C1+20\text{mm}/H-C2+16\text{mm}$, where H is the distance from the bottom surface of the concrete roof measured in the previous step to the bottom surface of the ceiling, and C represents the frame height. (For example: If H is 1000mm, and the suspension height is 156mm based on the installation method chosen, if choosing cover installation method, the screw length should be $H-C1+20\text{mm}=864\text{mm}$. If choosing flush installation, the screw length should be $H-C2+16\text{mm}=860\text{mm}$), determine the installation distance of the frame.

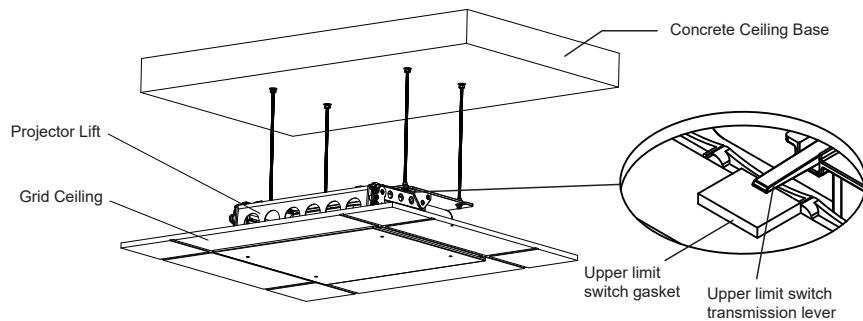

Figure 3 (overall diagram)

3. During installation, making sure to align the holes accurately, then lock it in place with nuts, ensuring the bottom frame of the lift just covers the ceiling frame, completely concealing any gaps left after installing the projector lift, as shown in Figure 3.

Note: The upper limit switch transmission lever is located below the top plate of the lift. When the lift is closed and the decorative panel touches the ceiling, the upper limit switch must make contact as shown in the figure. Otherwise, it may damage the lift. (For ease of installation, you can first remove the decorative panel, install and secure the projector, and then reattach the decorative panel.)

Projector installation (Figure 4)

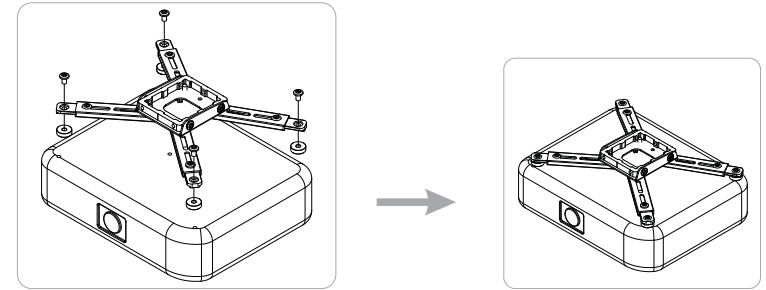

Figure 4

Remove the angle adjuster and mounting bracket assembly from the projector lift, align the mounting bracket hole in the assembly with the projector hole, and tighten it to the projector with screws. The installation is complete, as shown in Figure 4.

Projector angle adjustment (Figure 5)

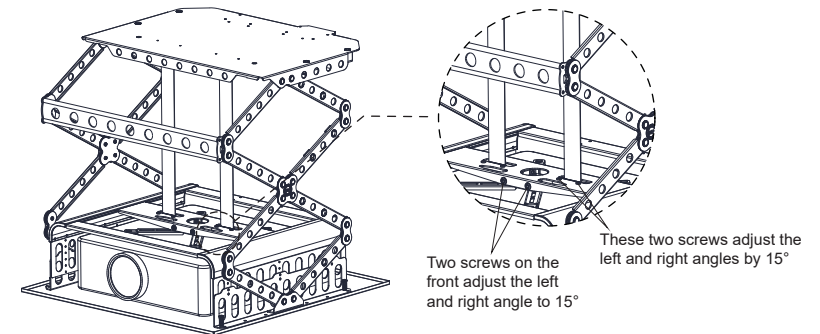

Figure 5

1. As shown in Figure 5, detect the level of the projector lift in the front and rear and left and right directions. If it is tilted, you can adjust the level of the projector by adjusting the up and down positions of the nuts in the picture. The center of gravity of the projector cannot be tilted too far forward.

Note: Make sure that the projector lift is smooth and unobstructed when moving up and down.

2. When adjusting the vertical angle, you need to loosen the front positioning screw, insert the screwdriver into the vertical adjustment hole and turn the screw.

Use a screwdriver to fine-tune the required angle, and then tighten the screws. (Vertical tilt angle: 15°)

3. When adjusting the horizontal angle, you need to loosen the positioning screw in front of the cloth belt, insert the screwdriver into the horizontal adjustment hole and turn

Use a screwdriver to fine-tune the required angle, and then tighten the screws. (Horizontal tilt angle: 15°)