



Hidetech B II Series

Recessed Motorized Screen

16:9 / 16:10 Concealed Ceiling Installation, Seamless Integration



Design Philosophy

The HideTech Series BII Recessed Tab-Tension Screen features an innovative in-ceiling mounting structure. When not in use, the screen is fully concealed within the ceiling, preserving a clean and cohesive interior appearance. It integrates seamlessly into both modern residential spaces and high-end commercial environments.

A separated housing noise-reduction design combined with a rubber isolation connection structure effectively minimizes vibration and resonance between the screen and ceiling, ensuring quiet and stable operation.

The second-generation structure accommodates a larger roller tube, ensuring even tension during deployment and retraction. This prevents localized wrinkles or misalignment and maintains long-term screen flatness for consistent image quality.



Core Advantages



All-New 20W DC Motor

- * 110–240V wide voltage input—no external transformer required
- * Built-in electromagnetic shielding for high resistance to interference
- * Durable design rated for over 20,000 cycles
- * Quiet performance with noise level under 50dB
- * S-curve motor control delivers smoother movement and reduces fabric strain

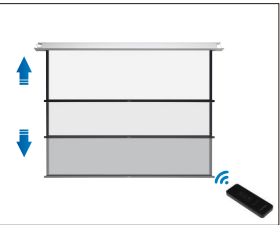

Electronic Limit Control

Customizable electronic upper and lower limits for precise travel positioning.

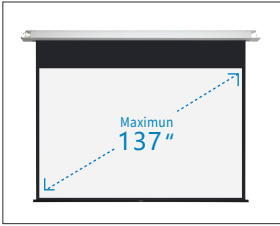

Large-Format Visual Experience

Supports screen sizes up to 137 inches (16:9), suitable for home theater and professional presentation applications.

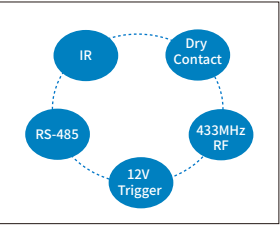

Multiple Smart Control Options

Supports RS-485, dry contact, 433MHz RF, infrared, and 12V trigger.

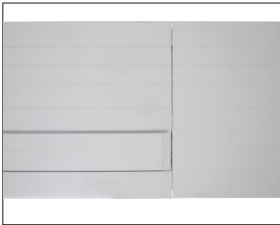

Optimized Bottom Bar Design

A fully enclosed bottom bar delivers a cleaner appearance while providing effective dust protection.

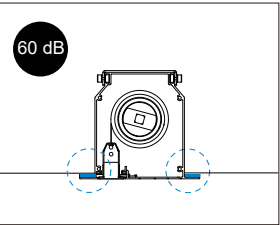

Rubber Isolation Connection Structure

Provides vibration damping to prevent screen oscillation or rippling, ensuring stable image performance.

Compatible Screen Fabrics



WM5

Fiberglass Matte White Fabric



GM5

Fiberglass Matte Grey Fabric

Product Specifications

Unit of measurement: mm

| Aspect Ratio | Diagonal Measurement | Viewing Area (W×H) mm | Black Drop (B3) mm | Lower Border (B2) mm | Left/Right (B1) mm | Product Height (A) mm | Product Length (L) mm |
|--------------|----------------------|-----------------------|--------------------|----------------------|--------------------|-----------------------|-----------------------|
| 16:9 | 92" | 2037×1146 | 700 | 30 | 40 | 1918 | 2477 |
| | 100" | 2214×1245 | 550 | 30 | 40 | 1867 | 2654 |
| | 106" | 2347×1320 | 400 | 30 | 40 | 1792 | 2787 |
| | 110" | 2435×1370 | 400 | 30 | 40 | 1842 | 2875 |
| | 120" | 2656×1494 | 400 | 30 | 40 | 1966 | 3096 |
| | 133" | 2944×1656 | 400 | 30 | 48 | 2128 | 3400 |
| 16:10 | 95" | 2037×1273 | 700 | 30 | 40 | 2045 | 2477 |
| | 103" | 2214×1384 | 550 | 30 | 40 | 2006 | 2654 |
| | 109" | 2347×1467 | 400 | 30 | 40 | 1939 | 2787 |
| | 113" | 2435×1522 | 400 | 30 | 40 | 1994 | 2875 |
| | 123" | 2656×1660 | 400 | 30 | 40 | 2132 | 3096 |
| | 137" | 2944×1840 | 400 | 30 | 48 | 2312 | 3400 |

